

UNIT C
 FIRST FLOOR 638 SQ. FT.
 SECOND FLOOR 1014 SQ. FT.
 THIRD FLOOR 1076 SQ. FT.
 TOTAL LIVING 2725 SQ. FT.

UNIT B
 FIRST FLOOR 721 SQ. FT.
 SECOND FLOOR 1026 SQ. FT.
 THIRD FLOOR 1089 SQ. FT.
 TOTAL LIVING 2836 SQ. FT.

UNIT A
 FIRST FLOOR 409 SQ. FT.
 SECOND FLOOR 829 SQ. FT.
 THIRD FLOOR 868 SQ. FT.
 TOTAL LIVING 2106 SQ. FT.

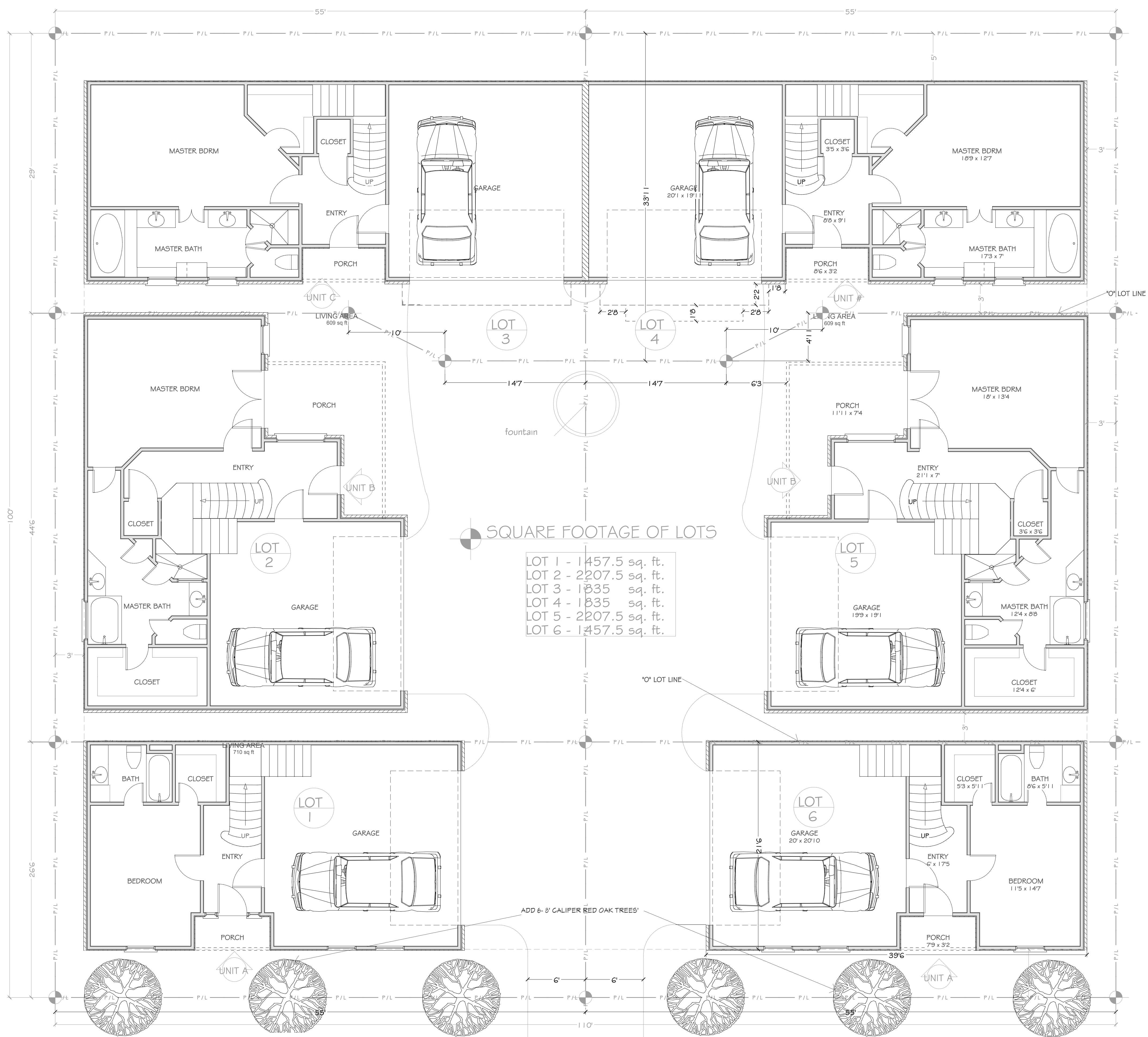

- SQUARE FOOTAGE OF LOTS
- LOT 1 - 1457.5 sq. ft.
 - LOT 2 - 2207.5 sq. ft.
 - LOT 3 - 1835 sq. ft.
 - LOT 4 - 1835 sq. ft.
 - LOT 5 - 2207.5 sq. ft.
 - LOT 6 - 1457.5 sq. ft.

SITE PLAN
 3/16" = 1'-0"

CALUMET PARK
SITE PLAN

800 Wilcrest suite 120
 Houston, Texas 77042
 PH. 713-784-8262
 FAX 713-784-5456
 CELL 713-806-1498

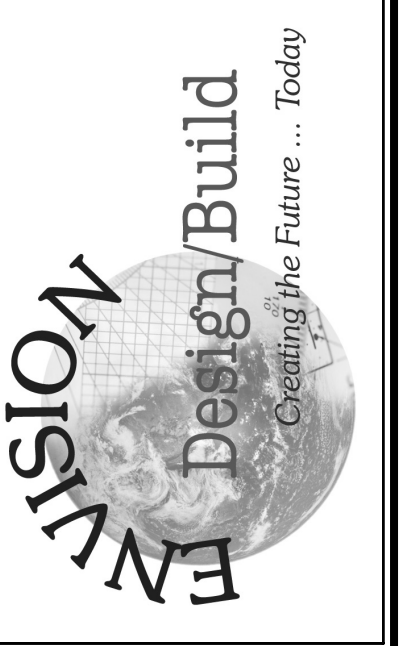

REVISIONS	DATE	NUMBER